

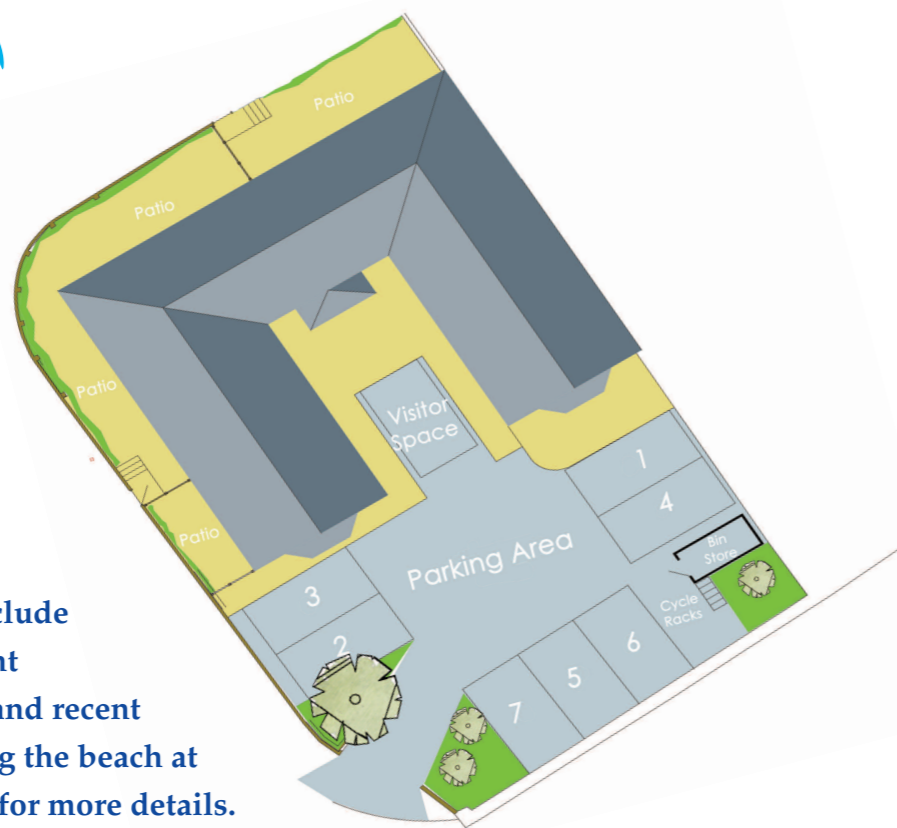

Site Plan

Richards Homes have established a reputation for the finest quality new houses and apartments. Recent schemes include the award winning development 'The Chestnuts' in Bishopston and recent Apartments scheme overlooking the beach at Rotherslade. View our website for more details.



Richards Homes
23 Chapel Street
Mumbles
Swansea
SA3 4NH

www.richardshomes.net

John Francis
www.johnfrancis.co.uk
Mumbles Office
01792 360060

RICHARDS
HOMES
Coastal & Countryside Homes

Bay View Apartments Mumbles

*Seven New
Luxury
Apartments.
In the
Heart of
Mumbles
Village.*



RICHARDS
HOMES
Coastal & Countryside Homes

Set in a quiet part of the bustling village of Mumbles, a short walk from the exclusive shops, bars and restaurants of Newton Road, the seafront at the Promenade and a 5 minute stroll from the beaches of Rotherslade and Langland.

An excellent location with views of the sea and surrounding area, each apartment will be finished to a high standard to include Sigma 3 kitchens with fully integrated appliances and granite worktops.

Villeroy and Boch bathroom suites with full tiling to bathroom floor and walls.

Each apartment has its own allocated private parking space. The new property will be built to the latest thermal efficiency standards, using the best materials to give the low running costs and maintenance benefits expected of a new property.

Ground Floor



Room Dimensions

Apartments 1 & 4

	Meters	Feet & Inches
Living room	5.5 x 4.8	18'0" x 15'8"
Kitchen	3.2 x 2.6	10'5" x 8'6"
Dining room	4.0 x 2.2	13'1" x 7'2"
Master Bedroom	4.0 x 3.2	13'1" x 10'5"
En suite	2.1 x 1.4	6'10" x 4'7"
Bedroom 2	3.3 x 2.8	10'9" x 9'2"
Bathroom	4.0 x 1.8	13'1" x 5'10"

Room Dimensions

Apartments 2 & 5

	Meters	Feet & Inches
Living room	5.5 x 3.4	18'0" x 11'1"
Kitchen	3.3 x 2.8	10'9" x 9'2"
Bedroom 1	3.6 x 3.5	11'9" x 11'5"
Bedroom 2	3.1 x 2.8	10'2" x 9'2"
Bathroom	2.4 x 2.1	7'10" x 6'10"

First Floor



Room Dimensions

Apartments 3

	Meters	Feet & Inches
Living room	3.7 x 3.5	12'1" x 11'5"
Kitchen	2.5 x 2.1	8'5" x 6'10"
Bedroom 1	4.1 x 2.4	13'5" x 7'10"
Bedroom 2	2.4 x 2.3	7'10" x 7'6"
Bathroom	2.4 x 1.9	7'10" x 6'2"

Second Floor



Room Dimensions

Apartments 6 & 7

	Meters	Feet & Inches
Living room	5.5 x 4.8	18'0" x 15'8"
Kitchen	3.2 x 2.6	10'5" x 8'6"
Dining room	3.8 x 2.2	12'5" x 7'2"
Master Bedroom	3.8 x 3.2	12'5" x 10'5"
En suite	2.1 x 1.6	6'10" x 5'2"
Bedroom 2	3.3 x 2.8	10'9" x 9'2"
Bathroom	3.8 x 1.8	12'5" x 5'10"

* Dimensions are based on overall and structural measurements.